

# RTF Inquiry and order form for rotary indexers type RTF (1) – V1

Firm \_\_\_\_\_

Contact person \_\_\_\_\_

Telephone / Fax \_\_\_\_\_

Projekt- / order.-no. \_\_\_\_\_

Offer-no. \_\_\_\_\_

Date \_\_\_\_\_

Index plate Diameter [mm] \_\_\_\_\_  
 Depth [mm] \_\_\_\_\_  
 Material or weight \_\_\_\_\_

Fixtures and workpieces Quantity \_\_\_\_\_  
 Mass/Station [kg] \_\_\_\_\_  
 Reference diameter [mm] \_\_\_\_\_

☐ Stop mode (fixed step time, variable dwell time)

☐ Continuous mode (fixed step and dwell time)

Required step time [s] \_\_\_\_\_

Required dwell time [s] (nur Durchlaufbetrieb) \_\_\_\_\_

Number of cycles [1/min] \_\_\_\_\_

Required service life (actual cycle time, normal 12,000 h)

☐ Additional forces and loads (please give details)

Please visit our website at [www.taktomat.de](http://www.taktomat.de) where you can download a program for calculating the rotary table data!

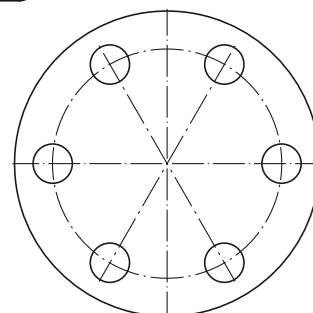
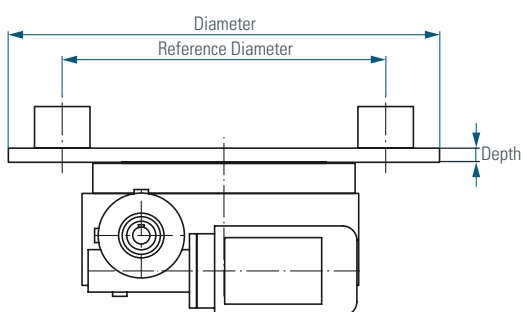

## Possible mounting positions for the drive units

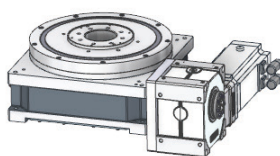

1SL90

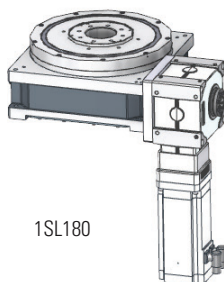

1SL180

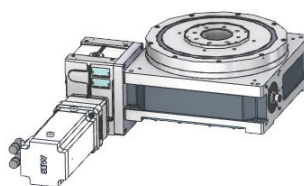

2SL90

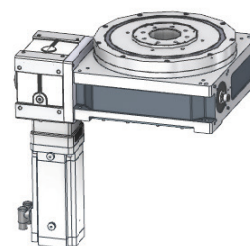

2SL180

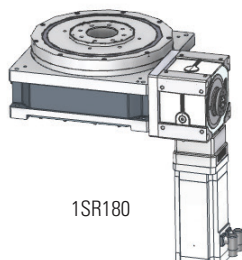

1SR180

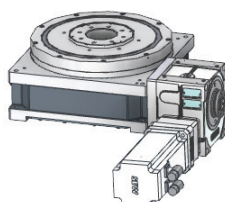

1SR 270

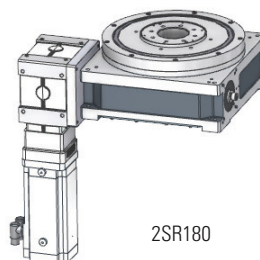

2SR180

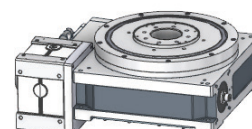

2SR270

This image shows a single sheet of white paper with horizontal ruling lines. The lines are evenly spaced and run across the width of the page. There are no margins, text, or other markings on the paper.